

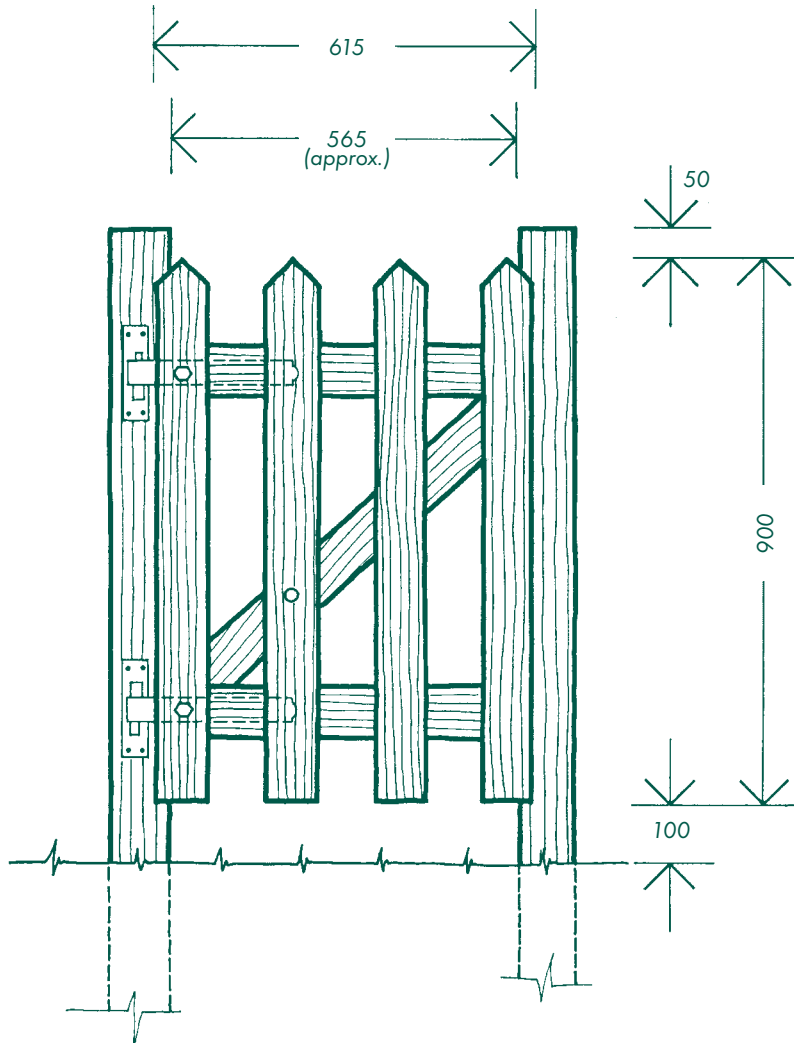

2.6A Front Elevation
Scale 1:12.5
0 500mm

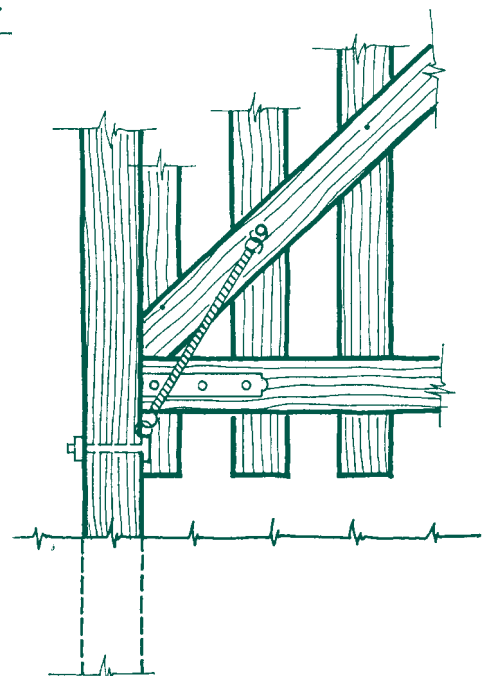

2.6C Rear Elevation - Detail of Spring
Scale 1:12.5
0 500mm



2.6B Plan
Scale 1:12.5
0 500mm



Conforms to BS 5709	Stockproof	Ease of use for Pedestrians	Accessible to Motorised Wheelchair Users	Accessible to Manual Wheelchair and Pushchair Users	Accessible to Horseriders	Accessible to Pedal Cyclists	Accessible to Motorcyclists
✗	✓	😊	✗	✗	✗	✓	✓



• **Notes**

A very simple design of 'self-build' timber pedestrian wicket gate developed by the Peak District National Park Authority. It is constructed wholly from 88 x 38 rails.

A key feature of this design is that its height and width can be made to suit the location in which it is to be installed.

The sizes most commonly used by the Peak Park are 900 high and 615 wide with four vertical rails; and 900 high and 440 wide with three vertical rails. One of the principal situations in which such gates are used in the Peak District is in stockproofing stone squeeze stiles.

The width of gate opening provided by this design is too small to conform to BS5709. It is only suitable for use by pedestrians and is not accessible to pushchairs or to wheelchair users. Care will therefore need to be taken as to the locations in which this type of gate is installed so as to ensure that it does not restrict access.

The gate is made self-closing by fixing a spring between the hanging post and the inside of the gate cross brace.

A cabin hook is used as a gate catch.

By virtue of its light construction, this type of gate is probably not appropriate for situations where there is heavy public use.

• **Construction and Installation Details**

Hanging Post : 1800 x 100 x 100.

Shutting Post : 1800 x 100 x 100.

Gate Fabrication : all from 88 x 38 rails, using galvanised screws.

Spring : 12" x 1.063" x 0.135" zinc plated. Bolted to hanging post and gate cross brace, using chain split links between the bolt and spring.

Hinges : 10" galvanised straight bands with 0.5" hooks on plates (top and bottom). Bolted and screwed to hanging post.

Catches : 4" light cabin hooks. Black epoxy coated.

When installing hanging and shutting posts, make the hole as narrow as possible and backfill with well rammed earth and stones. Concrete should not be required, except where ground conditions prevent the post hole being dug to the full depth.

The bottom hinge pin should be reversed, if necessary, to prevent gate removal.

• **Design Source and Contacts for Further Information**

Design Source: Ranger Service, Peak District National Park Authority, Aldern House, Baslow Road, Bakewell, Derbyshire. Tel. 01629 816200.

Supplier: Eliza Tinsley & Co. Ltd., Reddal Hill Road, Cradley Heath, West Midlands. B64 5JF for hinges, springs and cabin hooks.

• **User Notes : Design Modifications and Reference Information**

